

Technical data standard range

# Ball bearing with internal gearing

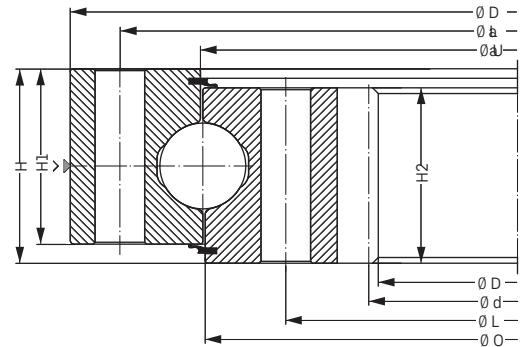
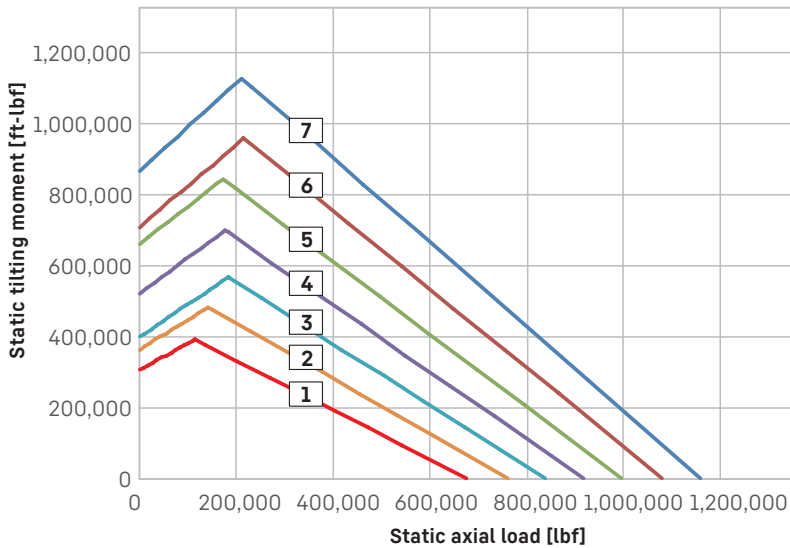

- 1 KUD00855-025VJ15-900-000
- 2 KUD00955-025VJ15-900-000
- 3 KUD01055-025VJ15-900-000
- 4 KUD01155-025VJ15-900-000
- 5 KUD01255-025VJ15-900-000
- 6 KUD01355-025VJ15-900-000
- 7 KUD01455-025VJ15-900-000

Bearing type	Bearing data								Bolt data					Gear data						Load rating			
	Weight	Outer diameter	Inner diameter	Total height	Outer diameter Inner ring	Inner diameter Outer ring	Height Outer ring	Height Inner ring	Pitch circle diameter Outer ring	Pitch circle diameter Inner ring	Number of bores per ring	Bolt diameter	Number of grease nipples per level	Pitch circle diameter	Module (metric)	Number of teeth	Profile shift	Tip reduction	Tooth width	Tooth forces (standard)	Tooth forces (maximum)	static	dynamic
	[lbs]	Da [inch]	Di [inch]	H [inch]	O [inch]	U [inch]	H1 [inch]	H2 [inch]	La [inch]	Li [inch]	n	M [mm]	n1	d [inch]	m [mm]	z	x* [inch]	k* [inch]	m [inch]	b [inch]	[lb <sub>f</sub> ]	[lb <sub>f</sub> ]	C <sub>stat</sub> [lb <sub>f</sub> ]
1	292.6	37.60	27.95	3.15	33.66	33.66	2.13	2.80	36.02	31.26	28	20	4	28.74	10	-73	-	-	2.80	8646.2	17,292.3	675,326	95,094
2	330.0	41.54	31.89	3.15	37.60	37.60	2.13	2.80	39.96	35.20	30	20	6	32.68	10	-83	-	-	2.80	8646.2	17,292.3	760,529	99,590
3	365.2	45.47	35.83	3.15	41.54	41.54	2.13	2.80	43.90	39.13	30	20	6	36.61	10	-93	-	-	2.80	8646.2	17,292.3	838,762	103,187
4	402.6	49.41	39.76	3.15	45.47	45.47	2.13	2.80	47.83	43.07	36	20	6	40.55	10	-103	-	-	2.80	8646.2	172,92.3	916,996	106,559
5	435.6	53.35	43.70	3.15	49.41	49.41	2.13	2.80	51.77	47.01	42	20	6	44.49	10	-113	-	-	2.80	8646.2	17,292.3	995,229	109,932
6	473.0	57.28	47.64	3.15	53.35	53.35	2.13	2.80	55.71	50.94	42	20	6	48.43	10	-123	-	-	2.80	8646.2	17,292.3	1,080,432	113,529
7	503.8	61.22	51.57	3.15	57.28	57.28	2.13	2.80	59.65	54.88	48	20	6	52.36	10	-133	-	-	2.80	8646.2	17,292.3	1,158,665	116,451



Have you already found the right slewing bearing – or are you still looking? Simply contact us, we will help you quickly and easily: [components@liebherr.com](mailto:components@liebherr.com)